



ACRIMO

Curains technology

MOTORIZED CURTAIN KIT – Product Manual

acrimotracks.com

01. Product overview - Kit

Kit

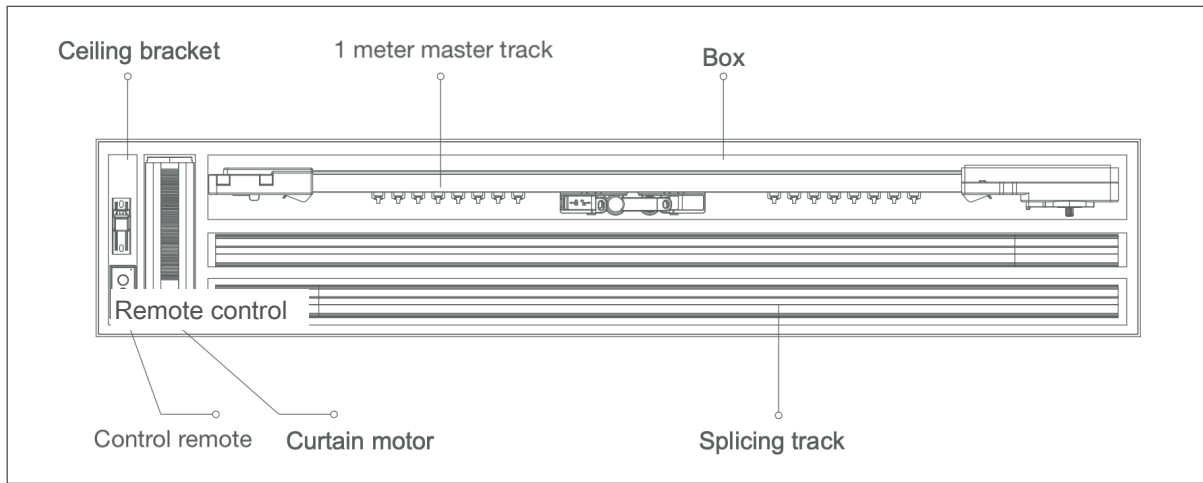

Motorized track system

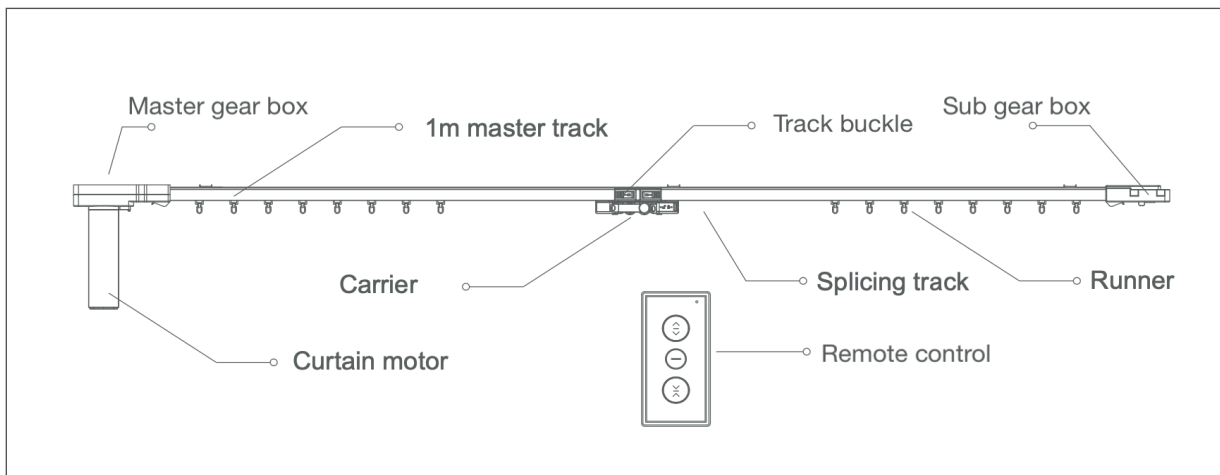

Curtain motor

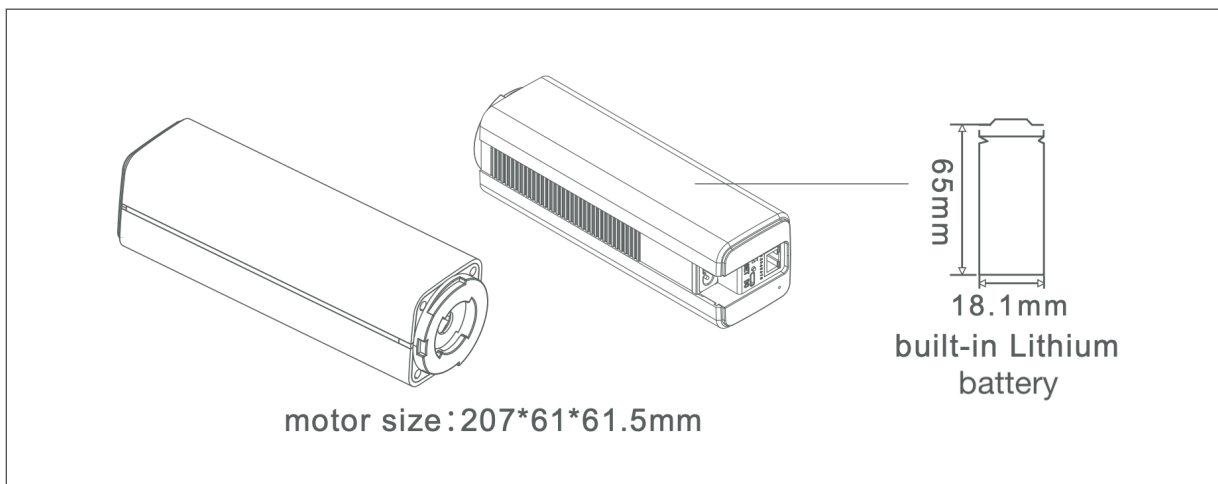

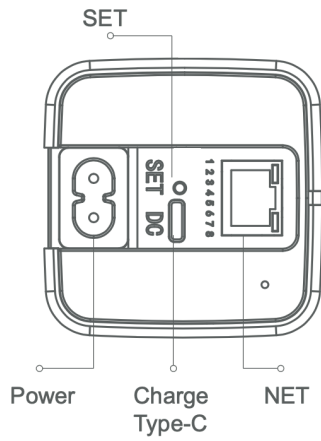

**Low voltage motor
(compatible with solar
panel)**

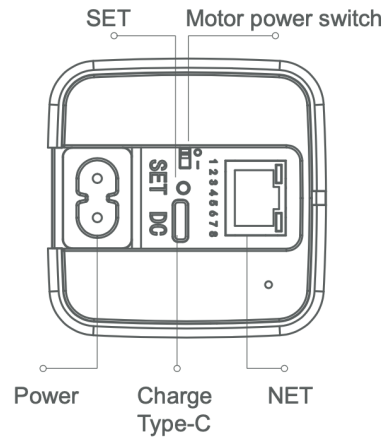

Motor with Wi-Fi

Important: if you have bought a motor that has a power switch, please change the position of the power switch to "-" (factory default position is "o") before plugging it in. You can then use it normally. If the motor is not going to be used for a long period of time, we recommend turning it off.

Technical parameters

Input voltage	AC110-240V~50/60Hz ; DC5V1A
Rated power	9w
Rated current	0.1A
Protect Grade	IP20
Running speed	Adjustable in 3 gears
Working temperature	-20°C~55°C
Working humidity	0-95%RH
Insulation Grade	Class A
Battery capacity	2500mAh(0.2C)
Battery voltage	3.7V
Discharge Voltage Cut-off	2.75V
Charge Voltage Cut-off	4.20V

Conexión al puerto RJ45



1# and 2# are control wires
(control the motor running direction - open or close)
3# is reserved wire;
4# is the public wire;
5# and 6# are RS485 B bus control wires;
7# and 8# are RS485 A bus control wires.

Switch installation using the RJ45 port connection



When both K1 and K2 are open, the curtains don't move;
When K1 is closed and K2 is open, the curtains open/close;
When K1 is open and K2 is closed, the curtains close/open;



When K1 (or K2) is closed and K2 (or K1) is open, the curtains open/close;
When both K1 and K2 are open, the motor keeps running;
When K1 (or K2) is closed and K2 (or K1) is open again, the motor stops;
When both K1 and K2 are open again, the motor stops;



The cycle would be as follows:
When K1 is closed, the curtains open/close.
When K1 is open, the motor keeps running.
When K1 is closed, the motor stops.
When K1 is open, motor stops.
This cycle would work the same way using the 2#control wire instead.
When both K1 and K2 are open again, the motor stops;

Remote control

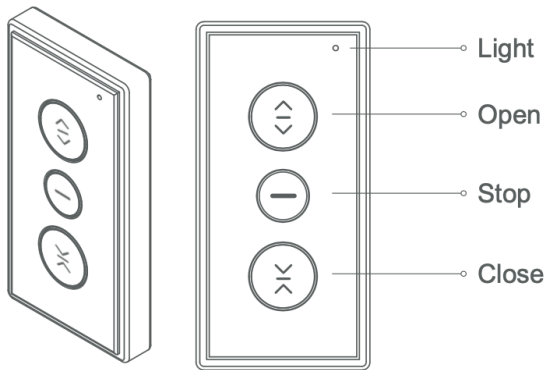

Technical parameters

Frequency: 433.92MHz
Channel: Single channel
Battery: 3V CR2032
Battery life: 2 years (Rated power 210MAH)
Distance: 50 m
Fixed mode: magnetic suction base
Size: 66mm X 33mm X 10mm

Installation

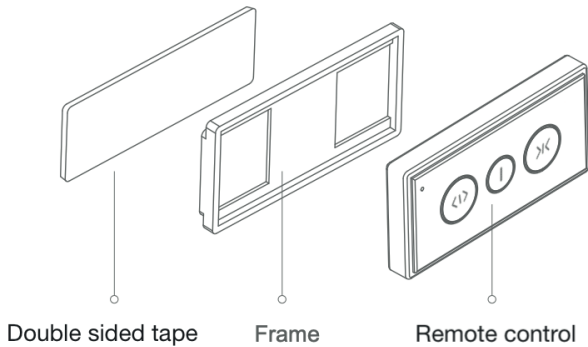

Battery replacement:

The battery cover needs to be removed by rotating it. The battery type is CR2032.

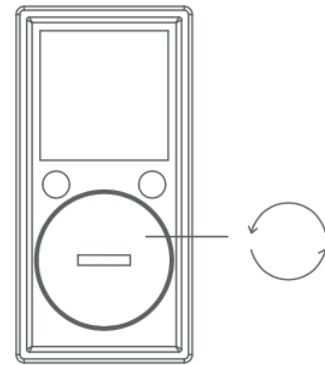

2. Motorized track assembly

Setting track length

(a) Select the profile sections that you will need to splice to achieve the desired track length and set them apart. Take the master track and unlock the sub gear box (by removing the gear box buckle, as shown in the image). Remove the latter from the aluminum profile.

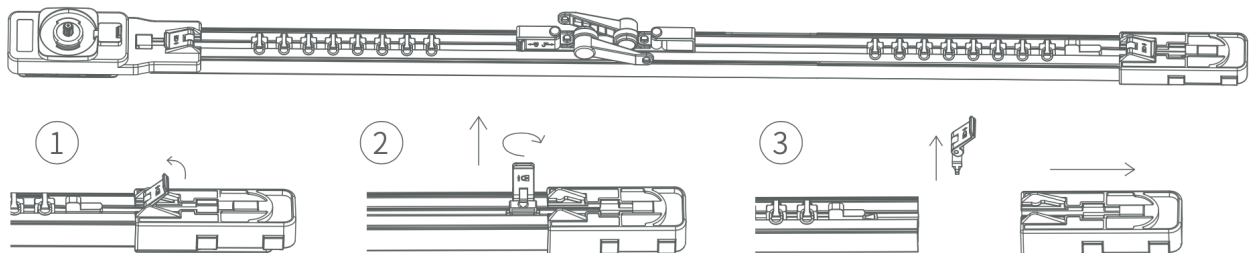

(b) Slide the track buckles into the profile and fix them when they are positioned as shown in the following image:

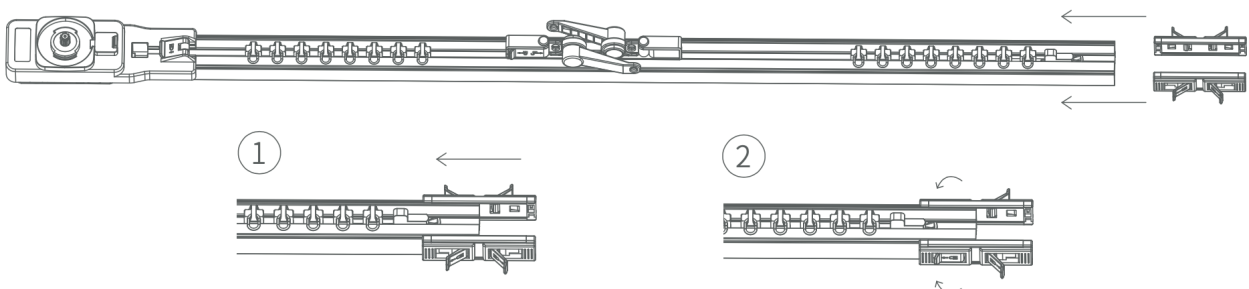

(c) Slide the first profile of your previous selection into the track buckles, splice both profiles tightly, and lock the buckles.

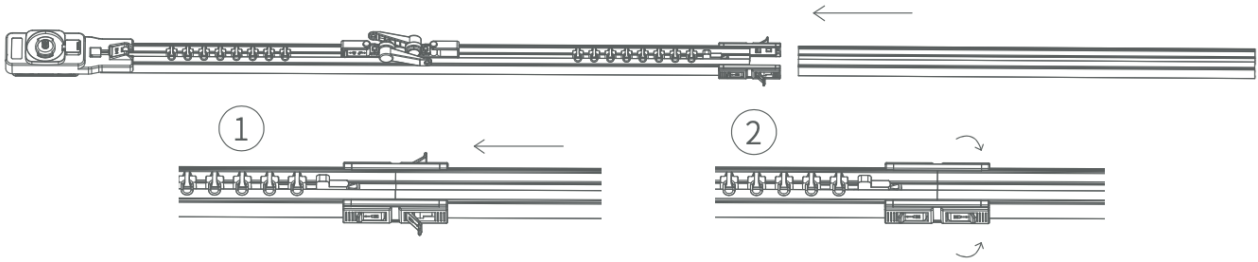

Repeat steps (b) and (c) to splice more profile sections.

(d) Slide the sub gear box back and pull the positioner to the end of the track: you will hear a 'click' when the positioner has reached its final position. Lock the sub gear box by using the gear box buckle.

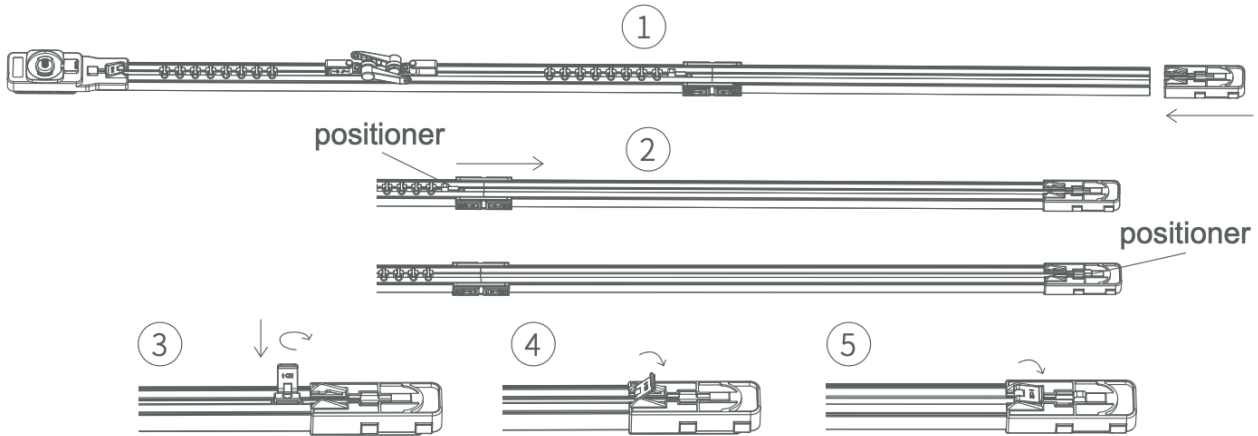

(e) Unlock the master carrier (important: do not unlock the sub carrier, the latter has a warning sticker to avoid mistakes). Pull the two carriers to both ends of the track and lock the master carrier again.

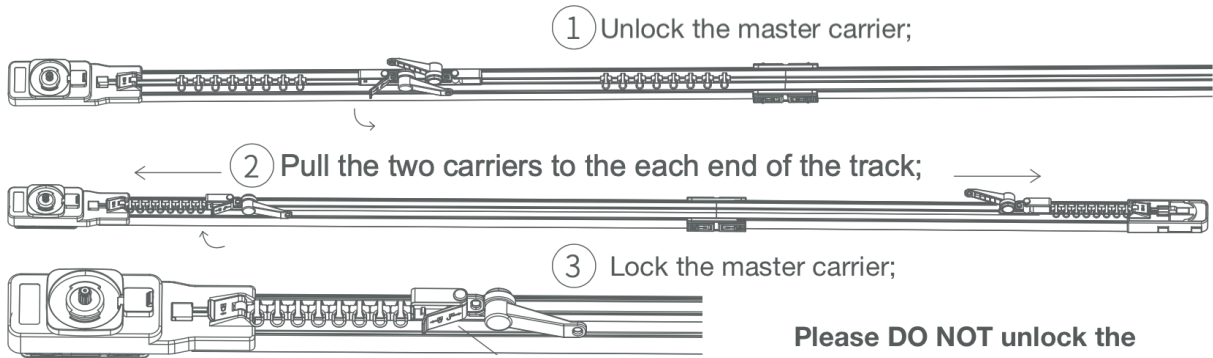

Add or remove runners

There is a set of runners already slid into the master track, but runners can be removed or added if needed. To do that, remove the buckles of both gear boxes (as shown in the image, important: do not pull out the master gear box from the track) and remove/add runners as needed.

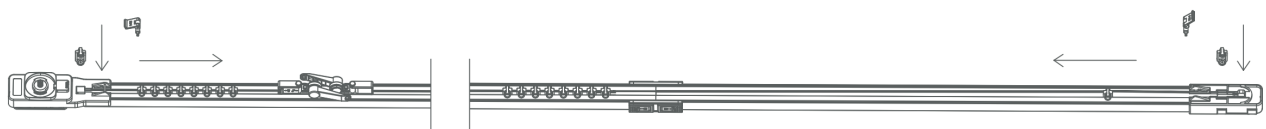

3. Motorized track installation

Ceiling installation

To measure the position of the brackets on the ceiling, we recommend installing them in the motorized track first. There must be a bracket close to each track buckle, and also next to the gear boxes (as shown in the image). Lastly, use additional ceiling brackets to ensure a maximum distance of 1 meter between them. Mark the position of the brackets on the ceiling, remove the latter from the motorized track, and install them. Once they are in place, you can install the motorized track.

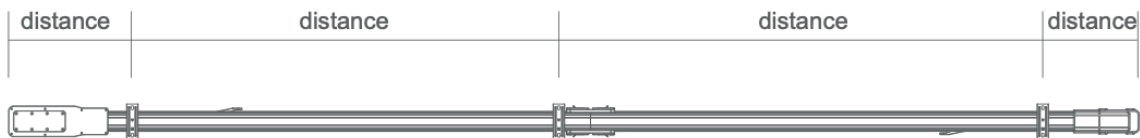

Motor assembly and disassembly

Insert the motor head into the master gear box (by making the shaft match the design of the pulley) and turn it 90° counterclockwise.
Important: change the position of the power switch to "-" before plugging it in, if you motor has one.

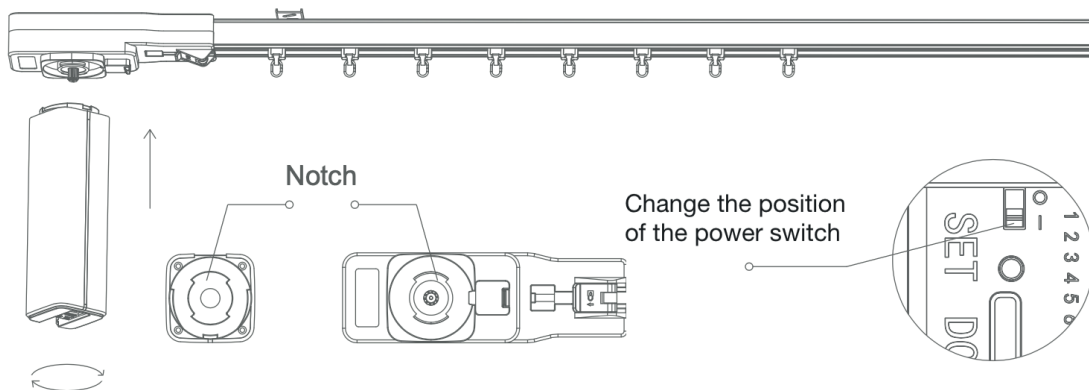

To disassemble the motor, pull the little buckle on the master gear box (shown in the image) and turn the motor 90° clockwise.

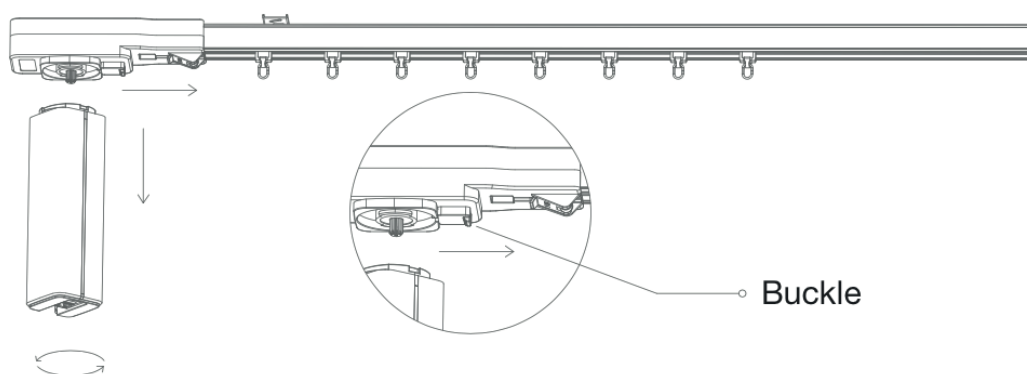

Remote control synchronization

Motor and remote control synchronization: follow the steps shown in the image to synchronize the motor with the remote control. Once done, press the open button and let the carriers travel all the way to the end of the track. Once they get there, the motor will register that position as the opening position (it will vibrate accordingly). Once the carriers have stopped moving, press the close button so the motor can register the closing position as well.

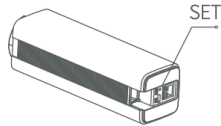

Press the SET button at the bottom of the motor. The light will flash once

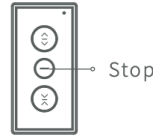

Then press the stop button on the remote. The motor will vibrate subsequently.

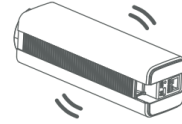

Speed adjustment of motor: the speed can only be controlled when you are using the remote control or the SmartTuya app. Please refer to the image below for more details.

Press the SET button at the bottom of the motor. The light will flash once

Choose speed before the motor starts

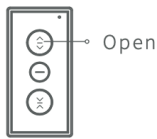

Press open/close once for the motor to run at silent speed

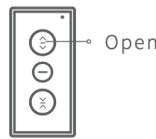

Press open/close twice for the motor to run at medium speed

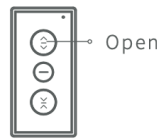

Press open/close three times for the motor to run at high speed

Choose speed while the motor is running

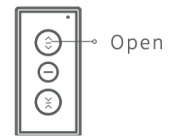

While the motor is running, you can still increase the speed by pressing the open/close button again. Once it gets to its maximum speed, it won't accelerate more.

Change the direction: if the activity of the motor does not match the intended outcome from pressing a given button of the remote control (example: the curtains open when you press 'close' on your remote control), you can change that by doing as follows:

Method 1

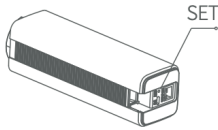

Press the SET button 5 times. As a result, the light will flash 5 times and the motor will vibrate. The direction is now changed.

Method 2

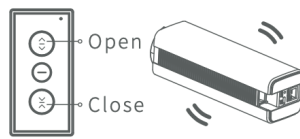

Press the open and close buttons at the same time. The motor will vibrate and the light will flash

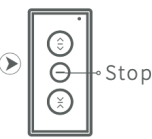

Then press the stop button and the light will turn off

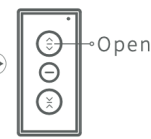
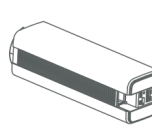

Lastly, press the open button again. The motor will vibrate once. The direction is now changed.

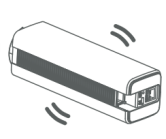

Set a limit position of opening/closing

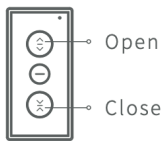

Set the curtains in the designated position, and press open and close at the same time until the motor vibrates. The yellow light will flash.

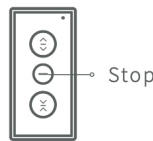
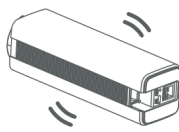

Press the stop button 5 times. The yellow light will turn off.

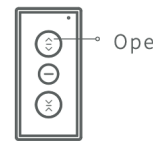
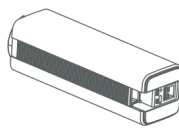

Press the open button once, the motor will vibrate. The limit position is now registered.

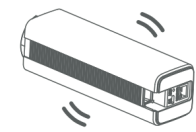

Delete a limit position of opening/closing

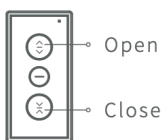

Press open and close at the same time until the motor vibrates. The yellow light will flash.

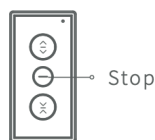
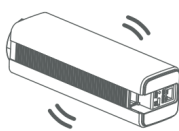

Press the stop button 3 times. The yellow light will turn off.

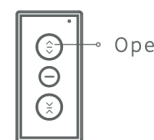
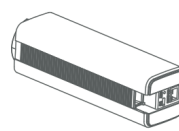

Press the open button once, the motor will vibrate. The position is now deleted.

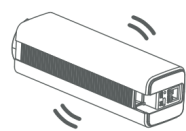

Set an intermediate position

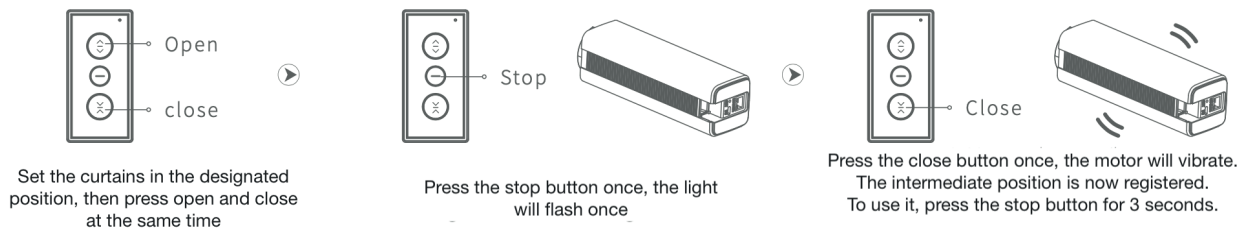

Factory reset

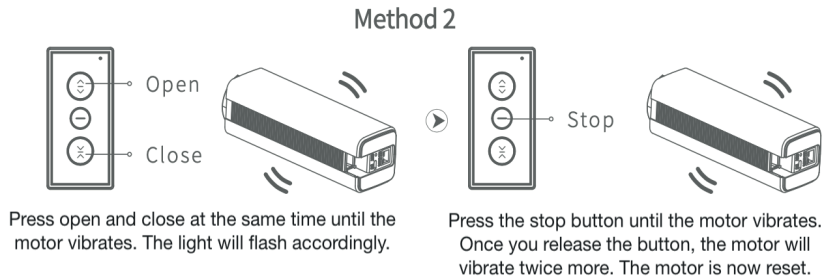
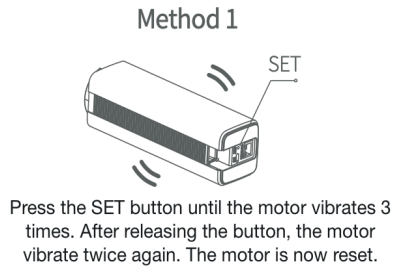

Remote copy code: if you need two remote controls to work with the same motor, you can follow the indications below. Be aware that remote A refers to the remote control that is already synchronized with the motor, and remote B is the second remote control that you want to synchronize.

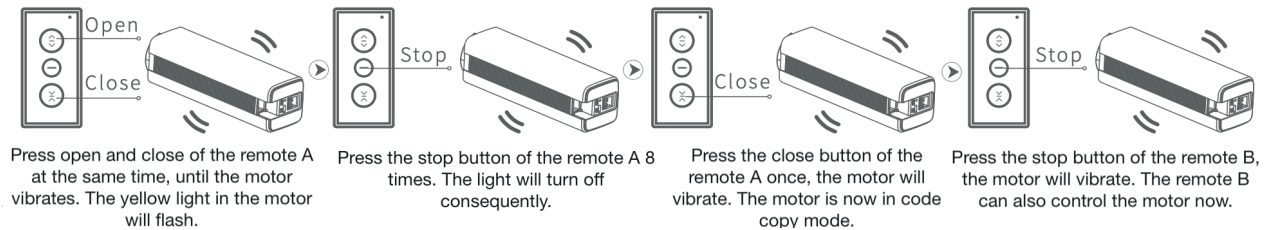

4. Do's and Don'ts

- This product is only for indoor use, do not use it in humid environment or outdoors.
- Do not splash water or other liquids on the product.
- Do not place the product near a heat source.
- The motor wires cannot be replaced. If the wires are damaged, the appliance should be abandoned.
- Do not try to repair the motor by yourself if any fault occurs during usage.